

LTR	CO	DATE	CHK

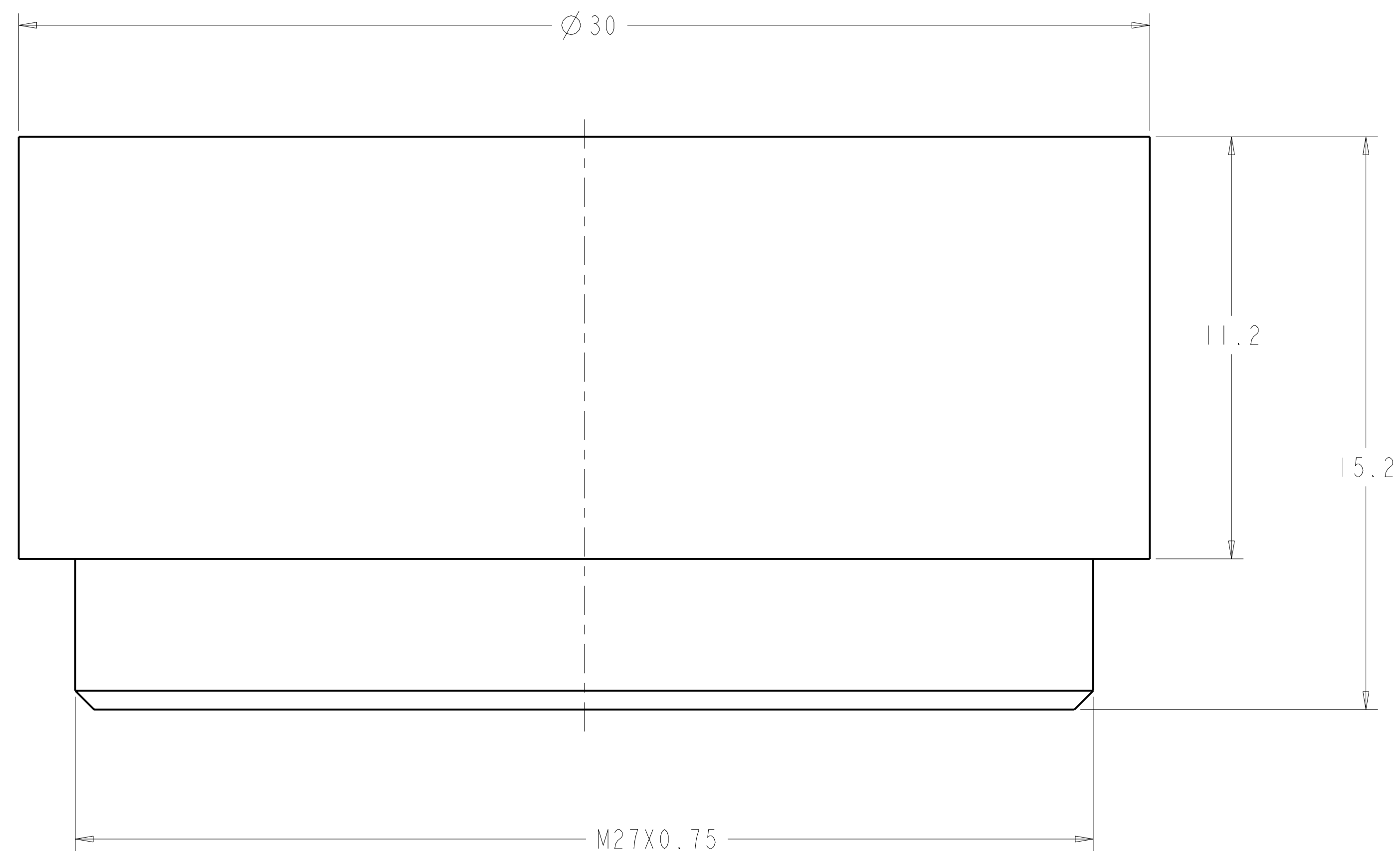

This document and the information and data contained herein are proprietary to and the exclusive property of Mightex Systems. This document and the information and data contained herein may not be used, copied, published or disclosed without the express prior written consent of Mightex Systems.

MATERIAL: ALUMINUM 6061	THE INFORMATION AND DATA CONTAINED HEREIN CONFORMS TO ASME Y14.5M-1994	DRAWN: _____ DATE: 08-Mar-10	Mightex Systems 1" focusing module
ALT MATL:	ALL UNTOLERANCED DIMENSIONS ARE BASIC	EDGE/COR BREAK: _____ RADIi INSIDE: _____ RADIi OUTSIDE: _____	
CASE DEPTH:	UNLESS OTHERWISE SPECIFIED: HARDNESS: 6.3 SURFACE FINISH	THIRD ANGLE PROJ 	SIZE NO. D 170032
SURFACE TREATMENT: BLACK ANODIZE	UNLESS OTHERWISE SPECIFIED, ALL DIMENSIONS ARE IN MM	PRO/ENGINEER® 	REL NO. _____ SHEET 1 OF 1